

# Please read this guide first!



Dear Customer,

Thank you for choosing our Hitachi product. We hope you will achieve the optimal efficiency from this high quality product which has been manufactured with state of the art technology.





Please make sure you read and understand this guide and supplementary documentation fully before use and keep it as a reference. Please include this guide with the unit if you hand it over to someone else. Observe all warnings and information herein and follow the instructions.

## Symbols and their meanings

These symbols are used throughout this guide:

	<b>DANGER</b>	This indicates warnings that, if ignored, could cause imminent danger of serious injury or death.
	<b>WARNING</b>	This indicates warnings that, if ignored, could result in serious injury or death.
	<b>CAUTION</b>	This indicates warnings that, if ignored, could result in minor injury or property damage.

### Warning symbols used in this manual

	Important information and recommendations regarding the use of the appliance.
	This indicates warnings or cautionary notes.
	This indicates prohibited actions that must not be performed.
	This indicates instructions that must be followed.



Protection class against electric shock.



This appliance has been produced in environmentally friendly facilities without harming the nature.

ENGLISH 2

# Safety precautions

Please follow these safety precautions.

This section describes safety precautions that must be followed in order to prevent injury to the user or other people, or damage to property. Please thoroughly read and follow the precautions in this manual.

- The severity of injury or damage that might occur if these precautions are ignored or the vacuum cleaner is used improperly is classified and explained below. Hitachi is not responsible for any injury or damage that occurs as a result of ignoring these precautions.
- The device complies with international safety standards.



## DANGER



- **Do not repair or modify any part of the vacuum cleaner. Do not disassemble any part of the vacuum cleaner unless instructed to in this manual.**  
Failure to heed this warning might cause leaking of the battery, the generation of heat, fire, or injury.
- **For repairs, please contact a Hitachi authorized service agent.**
- **Keep the vacuum cleaner and AC adapter away from water and other liquids.**  
Failure to heed this warning might lead to rupturing of the battery, fire, malfunction, or electric shock.
- **Do not connect the terminals of the vacuum cleaner and AC adapter with metal objects such as a wire and pin.**  
Do not carry or store with metal necklaces, hairpins, etc.  
Failure to heed this warning might cause the vacuum cleaner to malfunction or cause the battery to short-circuit, resulting in leaking, the generation of heat, rupturing, or fire.
- **Do not throw into fires or apply heat.**
- **Do not charge, use, or leave near sources of heat such as fire or a stove, under direct sunlight or in cars exposed to the sun, etc.**  
Failure to heed this warning might cause the battery to leak, generate heat, rupture, smoke, fire, deform, or malfunction.



## WARNING



This appliance is intended to be used in household and similar applications such as:

- Staff kitchen areas in shops, offices and other working environments;
- Farm houses;
- By clients in hotels, motels and other residential type environments;
- Bed and Breakfast type environments
- It is not fit for industrial use.



Warranty will be voided if the appliance is used for industrial or commercial purposes.



This appliance is designed for vacuuming dirt and dust particles. Do not attempt to use it on large objects which could block and damage the appliance.



This appliance is not designed for cleaning people or animals.



Only use original Hitachi accessories when replacing parts.



Check if the mains voltage on the rating label corresponds to your local mains supply.



Prevent damage to the power cable by not squeezing, bending, or rubbing it on sharp edges.



Avoid using extension cables or multipoint connectors. Plug the appliance directly in a wall socket if possible.



Keep packaging materials away from the reach of children.



Do not dismantle the appliance under any circumstances. No warranty claims are accepted for damage resulting from improper handling.



Keep hair, loose clothing, fingers, and all parts of the body away from openings and moving parts. Failure to do so could result in electric shock or personal injury.





## WARNING

### Outlet, plug, cord, and AC adapter



- **Use an 100-240V outlet.**

Do not use an extension cord, and do not plug the AC adapter in the same outlet as other appliances.



- **Periodically clean the plug of any dust and debris by using a dry cloth.**
- **Insert the plug of the AC adapter all the way into the outlet.**

- **Do not damage the cord.**

(Do not damage or modify the cord. Do not forcefully bend, bundle, pull, or twist it, and do not put it under heavy objects or pinch it between objects.)

- **Do not use the vacuum cleaner if the cord or the AC adapter's plug or connector is damaged, and do not plug the AC adapter into a loose outlet.**
- **The supply cord cannot be replaced. If the cord is damaged the appliance should be scrapped.**
- **Make sure the cord does not get caught in the rotary brush of the power head.**
- **Do not handle the plug (insert the plug into an outlet or remove the plug from an outlet) with wet hands.**
- **Do not touch the terminals on the AC adapter or vacuum cleaner.**
- **To charge the vacuum cleaner, use the AC adapter that was provided with the vacuum cleaner. Do not attempt to charge the vacuum cleaner by using other AC adapters.**
- **Do not use the AC adapter that was provided with the vacuum cleaner to charge any other type of battery, even if the battery in question is a rechargeable battery.**

Failure to heed this warning might cause fire or electric shock.

### If the vacuum cleaner malfunctions or you have noticed any of the following problems, stop using the vacuum cleaner immediately.



- The vacuum cleaner does not turn on when you press a control buttons, even though the battery is fully charged.
- The power turns on and off when you move the AC adapter cord or connector.
- The vacuum cleaner occasionally stops in the middle of operation.
- The vacuum cleaner makes strange sounds in the middle of operation.
- The vacuum cleaner or AC adapter is deformed or abnormally hot.
- The power cord is damaged or abnormally hot.
- It smells like something is burning.
- You have noticed some other problems or malfunction.

**Continuing to use the vacuum cleaner under these conditions could result in smoke, fire, or electric shock.**

**Turn off the vacuum cleaner immediately and unplug the AC adapter from the outlet. Then, contact a Hitachi authorized service agent to request an inspection and repair.**

### Power head (inlet)



- **Do not touch the rotary brush.**

Failure to heed this warning might cause injury. Be careful especially around children,

- **Do not place the power head on parts of your body (on top of your feet, etc.) when pulling the power head.**

Failure to heed this warning might cause injury.



## WARNING

### Others



- Do not use the vacuum cleaner near inflammable or combustible items or materials (kerosene, gasoline, paint thinner, benzine, toner, iron powder, detergents, large amounts of flour, aerosol sprays, flammable gas, cigarette butts, etc.), or to clean up such items or materials.
- Do not use the vacuum cleaner to clean up things with sharp points (thumbtacks, needles, toothpicks, hairpins, etc.).
- Do not use the vacuum cleaner to clean up suds or foam from carpet cleaners or other types of detergents.
- Do not use the vacuum cleaner outdoors.
- Do not wash any part of the vacuum cleaner with water unless that part is listed as a part that can be washed. Do not use the vacuum cleaner in the shower or bathtub.
- Do not charge or store the vacuum cleaner in a location prone to high humidity.

Failure to heed this warning might cause eruption, fire, electric shock, or injury.

- Do not lean the vacuum cleaner against a wall or other surface.
- Make sure that the power head is attached when using the vacuum cleaner stand.

The vacuum cleaner might fall over, becoming damaged or causing injury or damage to the floor.



## CAUTION

### Outlet, AC adapter, cord



- Hold onto the AC adapter when you unplug it. Do not pull on the cord. Pulling on the cord might damage the cord and cause short-circuiting, resulting in electric shock or fire.
- Do not wrap the cord around the charging station. Damaging the cord might cause electrical shock or fire.
- If you will not be using the vacuum cleaner for a long time, unplug the AC adapter.

Failure to heed this warning might lead to deterioration of the insulation, causing electric shock, short-circuiting, or fire.

### Exhaust port



- Do not block the exhaust port. Failure to heed this warning might cause overheating, leading to fire or the deformation of the vacuum cleaner.
- Do not expose your body to the air released from the exhaust port for long periods of time. Failure to heed this warning might cause minor burns.
- Do not use the appliance without filters, it may get damaged.



## CAUTION

### Power head (inlet)



- **Do not let the vacuum cleaner run for an extended period of time with the inlet blocked.**  
Failure to heed this warning might cause overheating, leading to fire or the deformation of the vacuum cleaner and power head.
- **Before performing maintenance on the vacuum cleaner, remove the power head from the vacuum cleaner.**  
Failure to heed this warning might cause injury.
- **Do not attach any of the parts of this vacuum cleaner to objects other than this vacuum cleaner.**  
Failure to heed this warning might cause overheating, leading to fire or the deformation of the power head.
- **Do not move the power head left and right while they are facing forward.**  
Doing so might damage floors or fabrics,
- **Do not use any of these attachments if any foreign objects (including sand or small pebbles) are stuck to the attachment.**  
Failure to heed this warning might result in damage to floors or cloth surfaces.
- **Do not use the vacuum cleaner under or in between blankets.**  
Failure to heed this warning might cause overheating, leading to fire or the deformation.

### Others



- **When carrying the vacuum cleaner, do not hold the dust case.**  
The vacuum cleaner might fall and cause injury or damage the floor.
- **Keep away from fire.**  
Failure to heed this warning might cause short-circuiting due to vacuum cleaner deformation, resulting in fire.  
If the vacuum cleaner is used near a flame, exhaust from the vacuum cleaner might cause the flame to grow into a conflagration.
- **Turn off the vacuum cleaner before performing maintenance.**  
Failure to heed this warning might cause injury.
- **Do not put the charging station where dew condensation occurs or in a humid place.**  
This might discolor the wall.
- **Do not drop the vacuum cleaner, power head, AC adapter, charging station, or any of the attachment accessories from high places.**  
Failure to heed this warning might cause injury or damage to the floor or dropped part.
- **Do not look directly into the LED lights.**  
Doing so might hurt your eyes.



## CAUTION

### Others



- Children should be supervised to ensure that they do not play with the appliance.
- This appliance is not intended for use by persons (including children) with reduced physical, sensory or mental capabilities, or lack of experience and knowledge, unless they have been given supervision or instruction concerning use of the appliance by a person responsible for their safety.
- Only allow children at least 8 years old to use the AC adapter. Give sufficient instruction so that the child is able to use the AC adapter in a safe way and explain to the child that it is not a toy to be played with.
- Instruct the child not to recharge non-rechargeable batteries because of the danger of eruption.
- Examine the AC adapter regularly for damage, especially the Cord, plug and enclosure. If the AC adapter is damaged, it must not be used.
- Cleaning and user maintenance shall not be carried out by children without supervision.
- Never operate the appliance without the filter.
- Clean the filter when necessary.

### Battery (lithium-ion battery)



## DANGER



- **Do not connect the battery to anything other than this vacuum cleaner. Do not disassemble, modify, or solder the battery. Do not charge the battery when it is not connected to the vacuum cleaner. Replacement of the battery is to be performed by a trained service technician.**  
Do not remove the battery except when disposing of this vacuum cleaner. Please consult with a Hitachi authorized service agent.
- **Do not touch the terminals or connect them by using metal items such as wires and pins.**
- **Do not transport or store the battery in the same container as metal objects such as necklaces, hairpins, coins, or keys.**
- **Do not subject the battery to strong physical shock. For example, do not put nails into the battery, hit the battery with a hammer, step on the battery, or throw the battery.**
- **Keep away from fire.**
- **Do not leave the battery near sources of heat such as a fire or stove, under direct sunlight, or in a car in the sun.**
- **Do not use any battery other than the one specified for this vacuum cleaner.**
- **Do not put the battery in a microwave or an oven.**
- **Do not submerge the battery in water or other types of liquid, or expose it to water or other types of liquid.**  
Failure to heed this warning might cause the battery to leak, generate heat, rupture, smoke, fire, electric shock, or injury.

## Battery (lithium-ion battery)



### DANGER



- **If the liquid inside the battery gets in your eyes, please do not rub them but thoroughly wash them with clean water immediately, and then consult a doctor immediately.**  
Failure to do so might cause damage to your eyes.
- **Do not short circuit the supply terminals.**



### WARNING



- **Do not use the battery if it is leaking or has an abnormal odor, discoloration, deformation, or damage due to being dropped or you notice something unusual.**

Failure to heed this warning might cause the generation of heat or smoke, rupturing, or fire. If liquid from the battery leaks onto the floor, it might damage the floor.

- **Keep the battery away from infants and children.**  
Failure to heed this warning might cause electric shock or injury.
- **If the battery is leaking, do not touch it with bare hands.**  
Failure to heed this warning might cause skin irritation.
- **Do not use batteries of different types or old and new batteries together.**



- **If liquid from the battery gets on your clothes, immediately wash them in clean water. If the liquid gets on your skin, consult a doctor.**

Failure to heed this warning might cause skin irritation.

- **Unplug the adaptor and remove the battery pack before any cleaning or maintenance procedure.**
- **Batteries shall be removed from the appliance before discarding the appliance.**
- **Disconnect the appliance from power supply before removing the battery.**
- **Please discard used batteries in accordance with local laws and regulations.**



## CAUTION



- **When charging the battery, make sure the ambient temperature is between 5°C and 35°C.**

Charging the battery in temperatures outside of this range might prevent the battery from being fully charged. As a result, the battery might take a long time to charge, or you might only be able to use the vacuum cleaner for a short time. Failure to heed this warning might cause the battery to deteriorate.

- **If the battery is still charging longer than the specified charging time, unplug the AC adapter.**
- **Do not touch the battery for a long period of time while charging or operating the vacuum cleaner.**  
Failure to heed this warning might cause minor burns.
- **Store the vacuum cleaner in a location with low humidity or little dust and debris.**  
Failure to heed this warning might cause the generation of heat or smoke, rupturing, or fire.
- **Please install/remove batteries as per the instructions specified in the user guide.**
- **Remove the depleted batteries from the appliance and dispose of these batteries in a safe way.**
- **If you do not intend to use the appliance for a long while, the batteries shall be removed.**
- **Use with ZB 2007 batteries only.**

## Usage notes

To prevent malfunction and other problems, please follow these instructions. Please thoroughly read these instructions, and to use the vacuum cleaner in accordance with these instructions.

- **Do not allow the vacuum cleaner, the power head, AC adapter, or attachment accessories to have strong physical shock.**

Failure to heed this warning might cause the deformation or damage.

- **Do not use the vacuum cleaner to clean up the following objects.**

Failure to heed this warning might cause strange odors or malfunction.

- Water or other liquids, wet objects, or desiccants.
- Large amounts of sand or powder, long string or thread, or glass.

- **Do not ride on the vacuum cleaner, the power head, or attachment accessories.**

Doing so might cause malfunctions.

- **Thoroughly air dry parts washed with water.**

Failure to heed this warning might cause strange odors or malfunction.

# 1 Important safety and environmental instructions

---

## Cleaning and care

### Warning

- Never use gasoline, solvent, abrasive cleaning agents, metal objects or hard brushes to clean the appliance.

### Storage

- If you do not intend to use the appliance for a long time, store it carefully.
- Unplug the appliance.
- Keep the appliance out of the reach of children.

## Handling and transportation

- During handling and transportation, carry the appliance in its original packaging. The packaging of the appliance protects it against physical damages.
- Do not place heavy loads on the appliance or on the packaging. The appliance may get damaged.
- Dropping the appliance may render it nonoperational or cause permanent damage.

## Waste batteries



Ensure that the waste batteries are disposed of in accordance with local laws and regulations.

The symbol on the battery and packaging indicates that the

battery delivered with the product should not be considered as household waste. This symbol may be used in combination with a chemical symbol in some regions. If the batteries contain more than 0.0005 % mercury and more than 0.004 % of lead, the Hg chemical is added for mercury and the Pb chemical symbol is added for lead under the symbol. By ensuring that the batteries are disposed correctly, you shall contribute to the prevention of potential damage to the environment and human health due to improper disposal of the batteries.

## Actions to be taken for energy saving

- To avoid redundant energy consumption while using the device, set the speed levels according to the floor you are vacuuming.
- Under normal conditions, low speeds are used to clean the hard floors, curtains and sofas, and high speeds are used to clean the carpets.

## 2 Overview

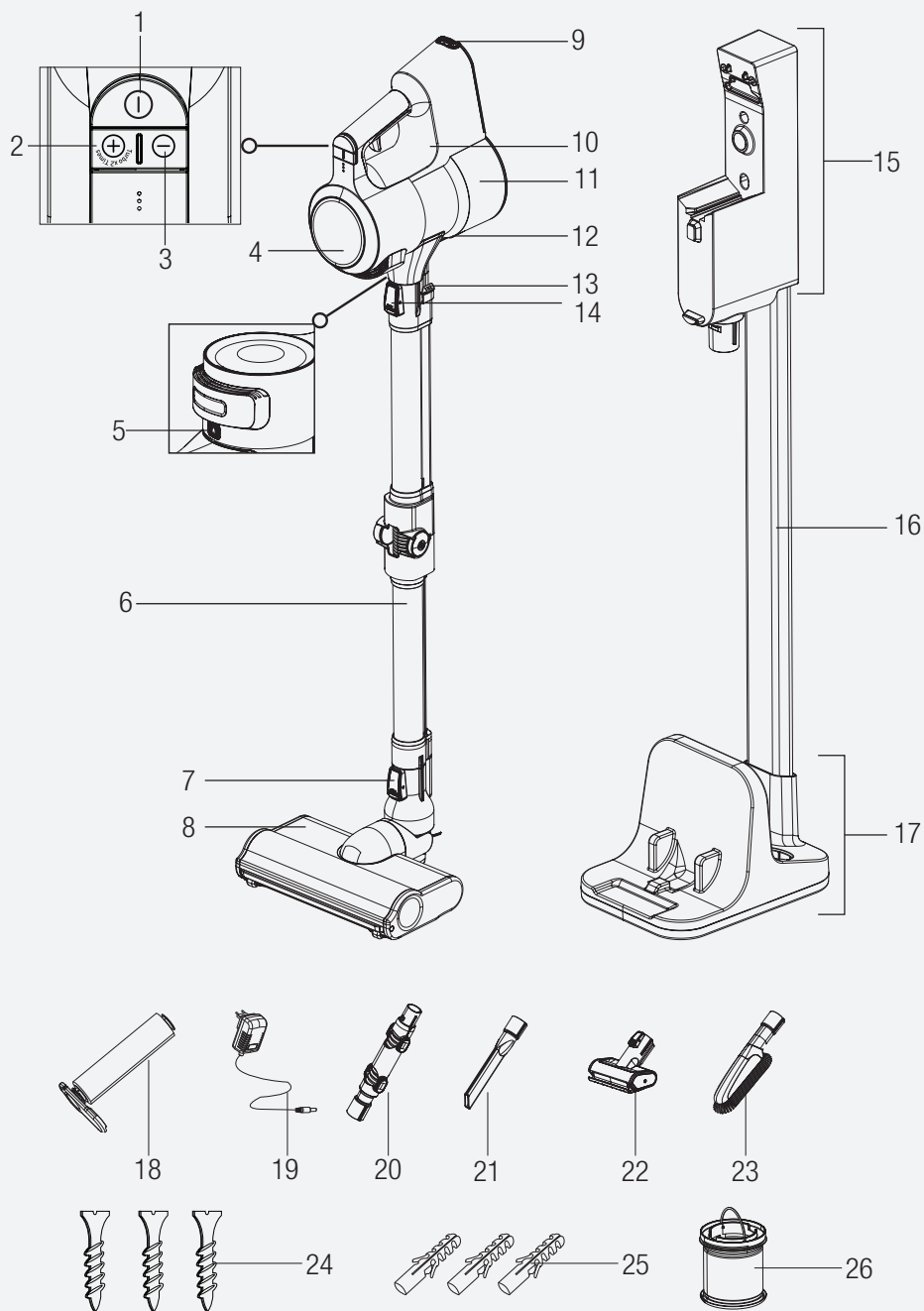



## 2 Overview

---

### 2.1 Controls and components

1. On-Off switch
2. Mode button +
3. Mode button -
4. LCD Display
5. Filter cover release button
6. Foldable tube
7. Brush release button
8. Electric turbo brush
9. Battery pack release button
10. Product body
11. Dust container
12. Dust container lid release button
13. Foldable tube button
14. Tube release button
15. Charging dock
16. Charging dock tube
17. Charging dock base
18. Hard floor roller
19. Adaptor
20. Elbow
21. Crevice tool
22. Mini turbo brush
23. Dust brush
24. Screw
25. Dowel
26. Replacement filter

### 2.2 Technical data

**Nominal input power:** 550 W

**Input:** 100-240V~ 50-60Hz 0.8A (max.)

**Output:** 36 V  $\square$  0.6 A

**Charging period:** 5-6 hours

**Operation period under maximum power:** up to 15 min.

**Operation period under medium power:** up to 30 min.

**Operation period under minimum power:** up to 60 min.

The rights to make technical and design changes are reserved.

#### Parameter of External Power Supply

<b>Manufacturer</b>	: Dongguan Yinli Electronics Co.,Ltd
<b>Model Identifier</b>	: YLS0241A-E360060 : VDE type plug shape : YLS0241A-U360060 : BS type plug shape
<b>Input Voltage</b>	: 100-240V~
<b>Input Frequency</b>	: 50-60Hz
<b>Input Current</b>	: 0.8A
<b>Output Voltage</b>	: 36.0V
<b>Output Current</b>	: 0.6A
<b>Output Power</b>	: 21.6W
<b>Average active efficiency</b>	: 87.19%
<b>Efficiency at low load(10%)</b>	: 79.58%
<b>No-load power consumption</b>	: 0.09W

The values provided with the appliance or its accompanying documents are laboratory readings in accordance with the respective standards. These values may differ depending on the use and ambient conditions.

## 2 Overview

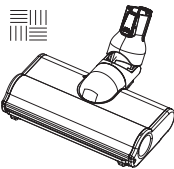
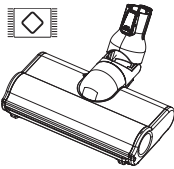
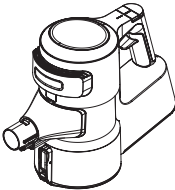
Intended Use	Speed rating	Operating period	
Hard floor	Minimum speed	Up to 60 min.	
	Medium speed	Up to 30 min.	
	Maximum speed	Up to 15 min.	
Carpet floor	Minimum speed	Up to 30 min.	
	Medium speed	Up to 15 min.	
	Maximum speed	Up to 7 min.	
Hand-held type	Minimum speed	Up to 90 min.	
	Medium speed	Up to 30 min.	
	Maximum speed	Up to 8 min.	



The operating periods specified above are valid under full charge (100%).



Electric turbo brush (8) detects the floor automatically. Operating periods may vary as per switching between floor types during operation.



Operating periods for hand-held type are valid for operation with no accessories, and operation with an elbow (20), with a dust brush (23) and with the narrow mouth nozzle (21). Period varies in case of operation with mini turbo brush (22).

## 3 Installation

### 3.1 Intended use

This appliance is intended for household use and it is not suitable for industrial use.

### 3.2 Installation of the mobile charging dock

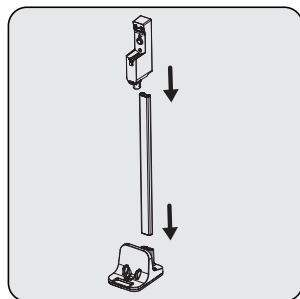

Install charging dock tube (16) to the charging dock base (17), then install the charging dock (15) to the charging dock tube (16).

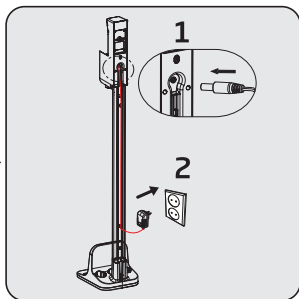

Install the adaptor to the charging dock (15). Plug in the charging adaptor (19).

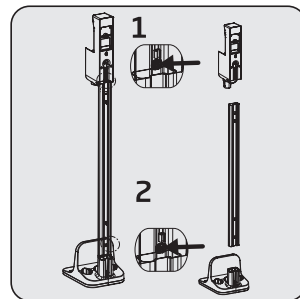

If you want to install the charging dock (15) to the wall, detach the charging dock from the tube (16) and support (17) using two separate buttons.

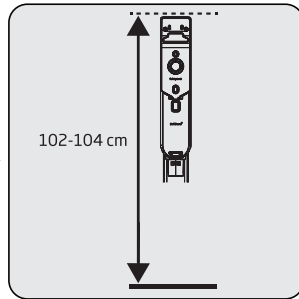

Position the charging dock (15) at a height of 102-104 cm from the ground.

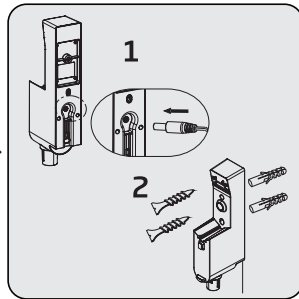

Install the adaptor (19) to the charging dock (15). Put the cord of the charging adaptor through the power cord securing ring behind the charging dock tube and secure the cord. Install the charging dock (15) to the wall using two screws (24) and two dowels (25).

## 3 Installation

### 3.3 Installation of the body and the brush

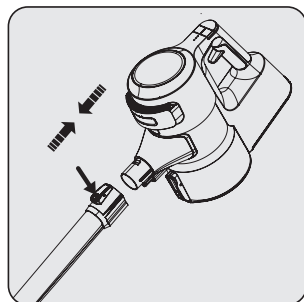

Install the tube to the end of the body (10).  
Install the tube to the product body (10).

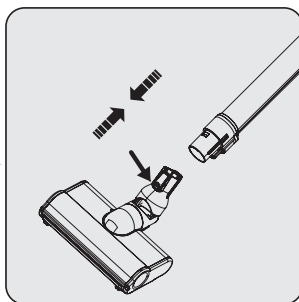

Press the electric turbo brush release button (7) on the electric turbo brush (8) and push it in the direction of arrow towards the wand.

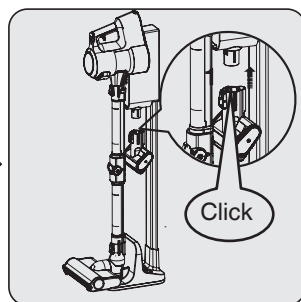

Push the mini turbo brush in the direction indicated by the arrow until sound "Click".

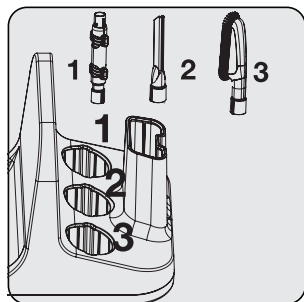

Place other accessories to the charging dock support (17).

## 4 Operation

### 4.1 Charging the appliance

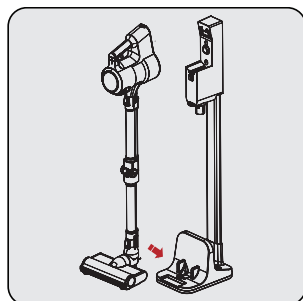

Secure the electric turbo brush (8) to the charging dock support.

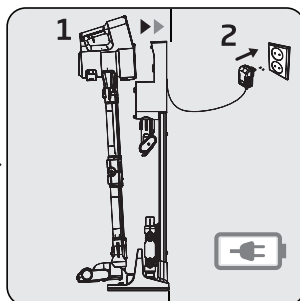

Install the body (10) to the charging dock (15). Plug in the charging adaptor (19).

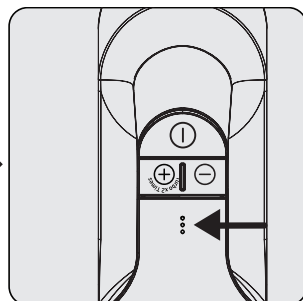

Flashing of the charge indicator LEDs in white colour indicates that the appliance is being charged.

– When all levels of the charge indicator LEDs are illuminated, this indicates that the charging of the appliance is completed.



It takes up to 5 hours to charge the appliance completely. The appliance must not be in operation while charging.

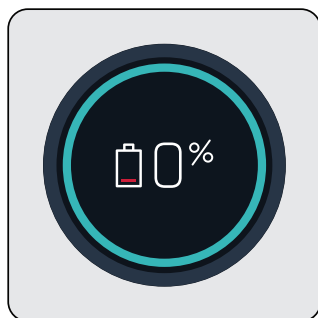

When you place the appliance to the charging dock (15), it starts to charge and the battery charge percentage shall be displayed on the screen (4). Percentage (%) and battery charge indicator are increased as the appliance is charged.



The screen (4) darkens 3 minutes after connecting the appliance to the charging dock and the battery status is displayed by 3 LEDs on the appliance. To see the charge percentage of the appliance, press + (2) or - (3) mode button once while it is charging.

## 4 Operation

### 4.2 Operation



It may be connected for charging before the complete discharging of the battery. The appliance may be kept continuously on the charging dock (15) until the next operation.

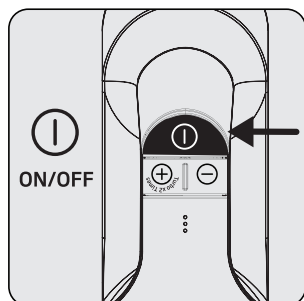

Press the on/off button (1) to operate the appliance. The appliance starts operating with the minimum speed when the on/off button is pressed.

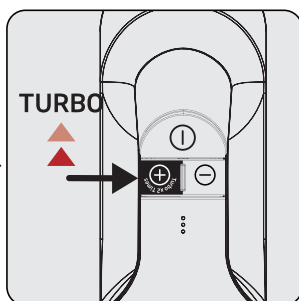

Press the "+" mode button (2) once to operate the appliance with medium speed. Press once more to operate it with the maximum speed.

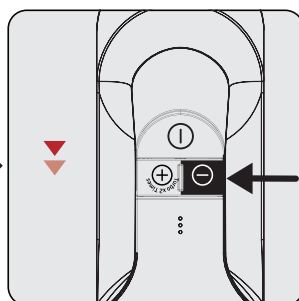

Press the "-" mode button (3) once to switch to a lower speed while operating at maximum speed or medium speed.

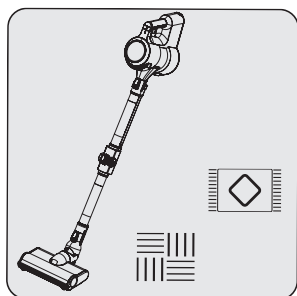

This appliance is suitable for use on carpets and hard floors.

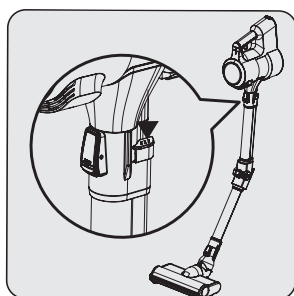

Press one of the two buttons (13) on the tube to fold the tube. Thus, you may reach hard-to-reach areas such as the areas under the seats.



If the adaptor on the charging is plugged in, the appliance stops operating automatically if it is placed on the charging dock (15) while it is being operated.

## 4 Operation

### 4.3 LCD Display

#### 4.3.1 Main Screen

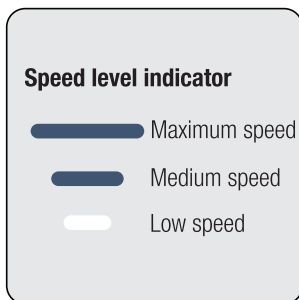
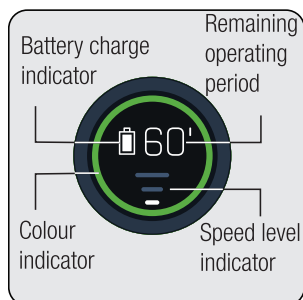

**Battery charge indicator:**

Varies as per the remaining operating period.

**Remaining operating period:**

Indicates the remaining charge level in minutes as per the speed level and floor type used.

**Colour indicator:** Indicates your remaining operating period as green, yellow and red.

**Speed level indicator:**

Indicates the speed level that the appliance is being used.

For example, all three bar indicators are illuminated in white while using the appliance at maximum speed.

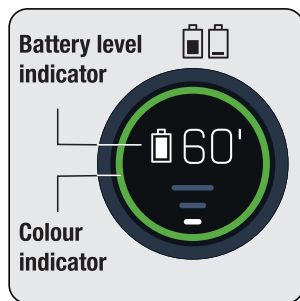

The circle around the display (4) changes colour as per the remaining operating period. Simultaneously, the battery charge indicator changes as per the remaining operating period.

**Colour indicator:**

**Low speed level**

- Illuminates in green between 60 minutes and 30 minutes at full charge.
- Illuminates in yellow in the last 30 minutes to 3 minutes.
- Illuminates in red in the last 3 minutes of remaining charge.

**Medium speed level**

- Illuminates in yellow between 30 minutes and 3 minutes at full charge.
- Illuminates in red in the last 3 minutes of remaining charge.

**Maximum speed level**

- Illuminates in yellow between 7 minutes and 3 minutes at full charge.
- Illuminates in red in the last 3 minutes of remaining charge.



The remaining operating period, battery charge indicator and colour indicator displayed on the screen (4) vary as per the speed level and floor type used.

## 4 Operation

### 4.3.2 Changing Speed Level



When the speed level is changed, a moving brush symbol and the speed level indicator shall be displayed on the screen. Then, the main screen shall be displayed.

### 4.3.3 Charging

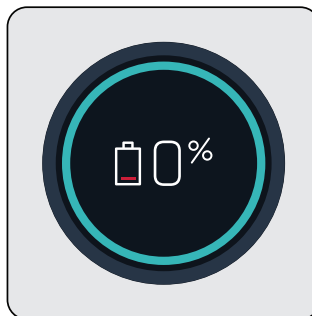

When you place the appliance to the charging dock (15), it starts to charge and the battery charge percentage shall be displayed on the screen (4). Percentage (%) and battery charge indicator are increased as the appliance is charged.



The screen darkens 3 minutes after connecting the appliance to the charging dock (3) and the battery status is displayed by 3 LEDs on the appliance.

To see the charge percentage of the appliance, press + or - mode button once while it is charging.

### 4.3.4 Automatic floor detection



When the auto floor detecting brush (8) moves from a carpet floor to a hard floor, the figures shown above shall be animated on the screen (4).



## 4 Operation



The smart floor nozzle detects the floor type faster when the suction tube is held more vertically.

### 4.3.5 Warning screens

#### 4.3.5.1 Filter blockage warning

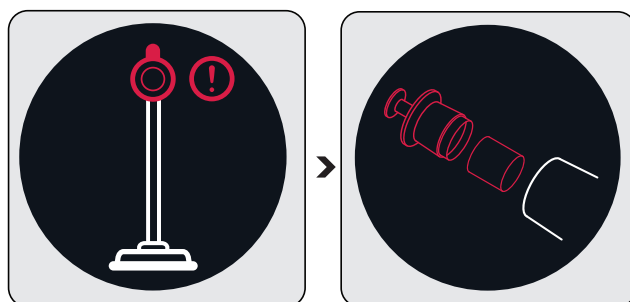

The filters shall be cleaned regularly to prevent loss of performance. When it is not cleaned regularly (in case of excessive dust), a filter cleaning animation is displayed on the screen for a very short period of time to indicate that the metal filter and inlet foam shall be cleaned. However, the appliance continues to operate.



It is recommended to clean the metal filter and the inlet foam as described in Section “**5.2 Cleaning of the metal filter and inlet foam**” before continuing with the cleaning.

## 4 Operation

### 4.3.5.2 Brush blockage warning

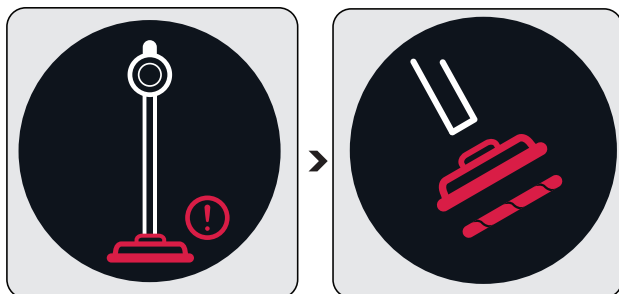

When the turbo brush is blocked or too much hair, etc. materials are tangled on the rotating roll, the animation indicating the brush blockage warning is displayed on the screen continuously and the appliance stops operating.



It is recommended to clean the brush as described in Section “**5.4 Cleaning of the brush**” before continuing with the cleaning. Remove the turbo brush (8) from the foldable wand (6). Inspect the turbo brush to the wand connection and remove any blockages.

### 4.3.5.3 Suction path blockage warning

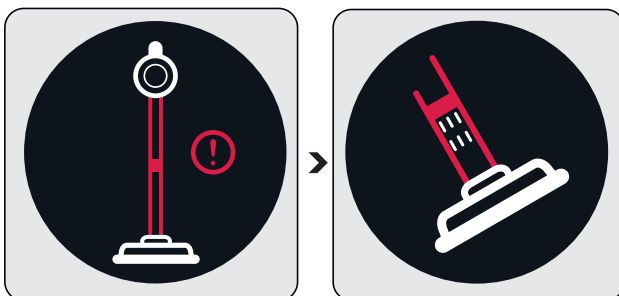

When the suction path is blocked, the animation indicating that the suction path is blocked is displayed on the screen continuously and the appliance stops operating. Determine the reason of the blockage of the suction path.



It is recommended to determine the reason of blockage as described in Section “**5.5 Cleaning of the blockages**” before continuing with the cleaning. Remove the turbo brush (8) from the foldable wand (6). Remove the foldable tube from the body of the appliance. Inspect the turbo brush to the wand connection and remove any blockages. Inspect the wand from the inlet and outlet ends of the foldable wand, and remove any blockages. Inspect the vacuum nozzle of the appliance body (10) and remove any blockages.

## 4 Operation

### 4.4 Accessories

You may use the accessories by installing them to the end of the body.

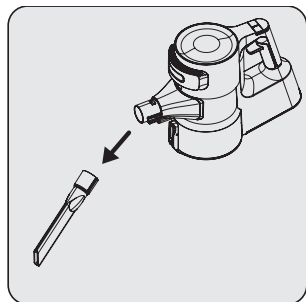

**Crevice tool (21):** Suitable for vacuuming the rear of the furnitures, hard to reach areas and narrow areas.

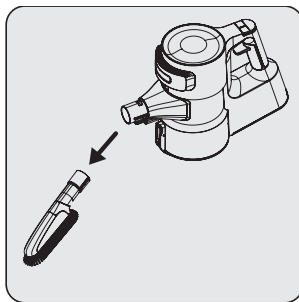

**Dust brush (23):** Suitable for vacuuming curtains, waxed furniture and delicate and fragile objects.

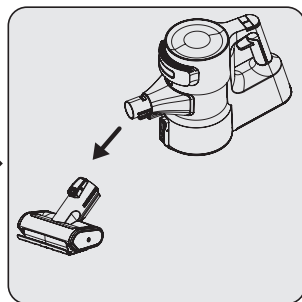

**Mini turbo brush (22):** Suitable for vacuuming floorings, stair steps, car interiors, sofas and seat, etc. It is also used for vacuuming pet hair on such surfaces.

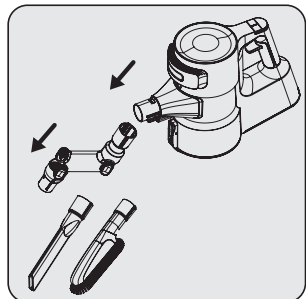

You may use the elbow (20) by installing it to the end of the body (10) to access hard to reach places.

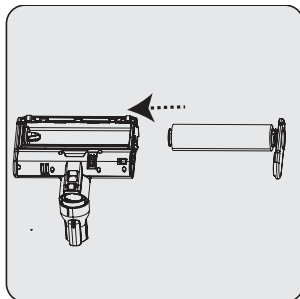

This accessory is suitable for use on delicate hard floors (natural hardwood, etc.).

## 5 Cleaning and maintenance

Turn off and unplug the appliance before cleaning.



**CAUTION:** Do not use benzene, solvents, abrasive cleaners, metal objects or hard brushes to clean the appliance.



**CAUTION:** Deformation may occur on the filters within time as a result of usage. It shall be replaced with a new one to prevent loss of performance. Contact with the customer services to buy a new one. (see P. 25)

### 5.1 Cleaning of the dust container



We recommend you to clean the dust container (11) after each operation.

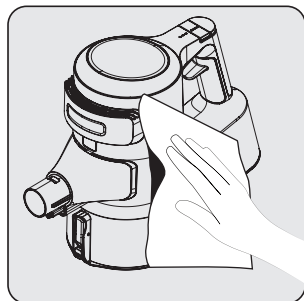

Wipe the surface of the body with a wet cloth (10).

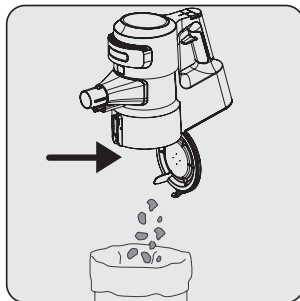

Press the dust container lid release button (12) to open the dust container (11) and discharge the dust collected inside.

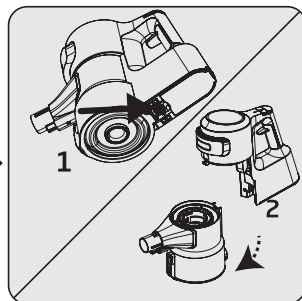

Push the trigger under the appliance to clean the dust container (11). Detach the dust container (11) from the body (10).

## 5 Cleaning and maintenance

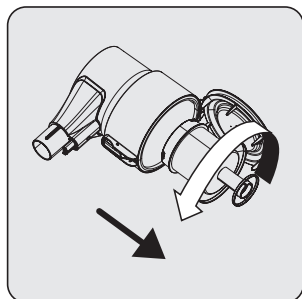

Remove the metal filter and inlet foam inside the dust container (11) by rotating the metal filter counter-clockwise.

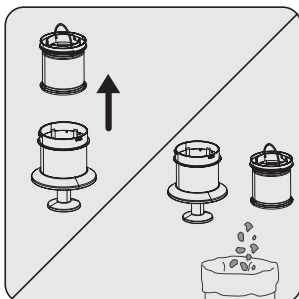

Remove the inlet foam inside the metal filter. Remove the dust on the metal filter and inlet foam by tapping them to a hard surface such as a waste bin or by using a brush.

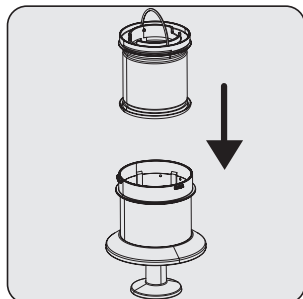

Install the inlet foam to the metal filter.

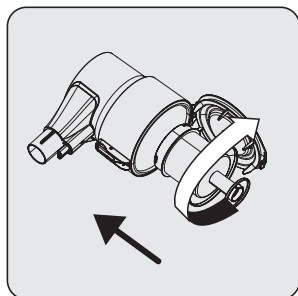

Install the metal filter inside the dust container (11) by rotating it clockwise.

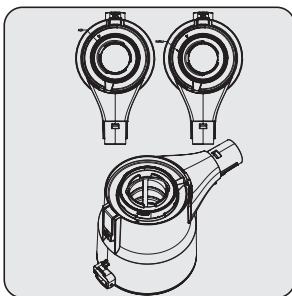

While installing the metal filter and inlet foam to the dust container you have detached them from, place them as per the lock symbols on the dust container.

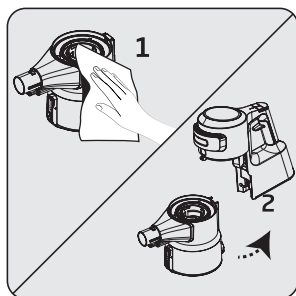

1. Wipe the body (10) with a wet cloth.
2. Install the body (10) to the dust container (11).

## 5 Cleaning and maintenance

### 5.2 Cleaning of the metal filter and inlet foam



The metal filter and inlet foam shall be cleaned regularly.

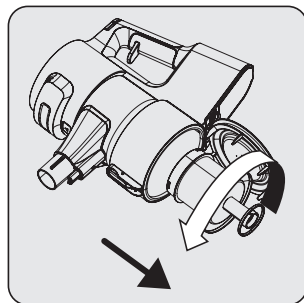

Remove the metal filter and inlet foam inside the dust container (11) by rotating the metal filter counterclockwise.

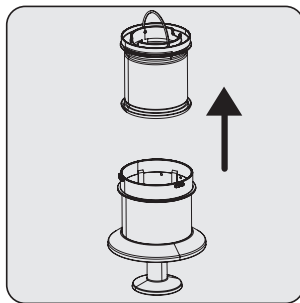

Remove the inlet foam inside the metal filter.

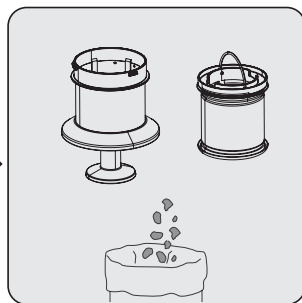

Remove the dust on the metal filter and inlet foam by tapping them to a hard surface such as a waste bin or by using a brush.

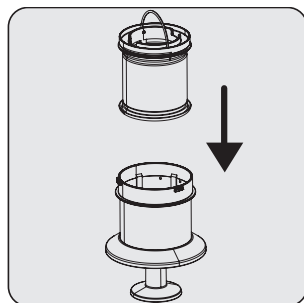

Install the inlet foam to the metal filter.

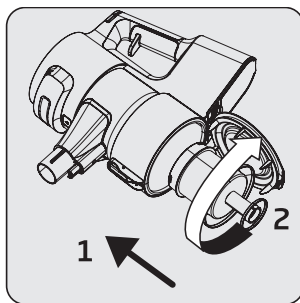

Install the metal filter and inlet foam inside the dust container (11) by rotating the metal filter clockwise.

## 5 Cleaning and maintenance



Clean the metal filter and inlet foam by washing under running cold water once a month after removing the dust on them.

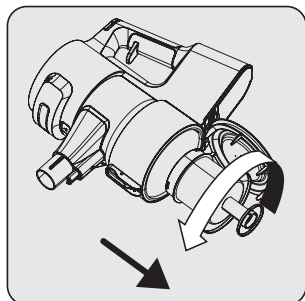

Remove the metal filter and inlet foam inside the dust container (11) by rotating the metal filter counterclockwise.

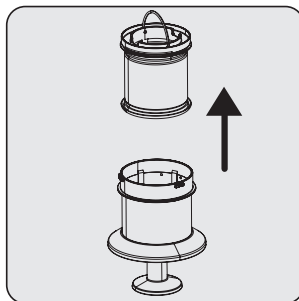

Remove the inlet foam inside the metal filter.

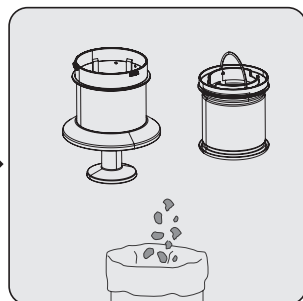

Remove the dust on the metal filter and inlet foam by tapping them to a hard surface such as a waste bin or by using a brush.



**CAUTION:** Wash with cold water. Warm water deteriorates the structure of the filter.

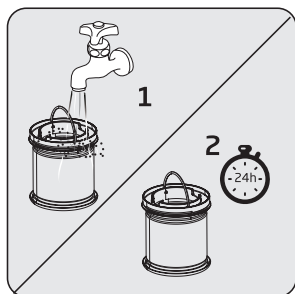

Wash the inlet foam under running cold water and let it dry.

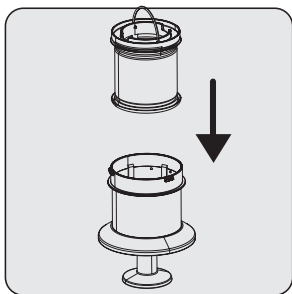

Install the dried inlet foam to the metal filter.

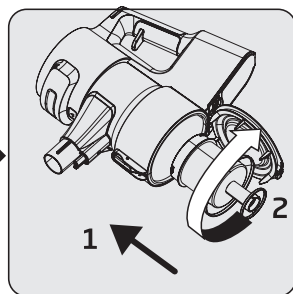

Install the metal filter and inlet foam inside the dust container (11) by rotating the metal filter clockwise.



It may take 24 to 48 hours to dry the washed inlet foam. Reinstall once it is dried.

## 5 Cleaning and maintenance

### 5.3 Cleaning of the EPA E12 Filter and outlet foam



Clean the EPA E12 filter and outlet foam regularly.



**CAUTION:** Do not wash the EPA E12 filter.

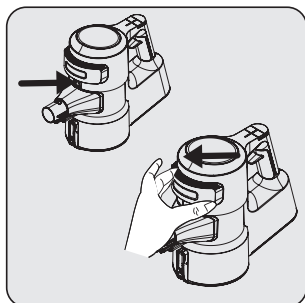

Remove the lid simultaneously while pressing the EPA E12 filter release button.

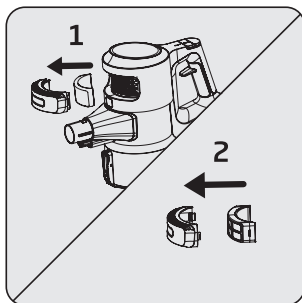

Remove the EPA E12 filter and the outlet foam inside it.

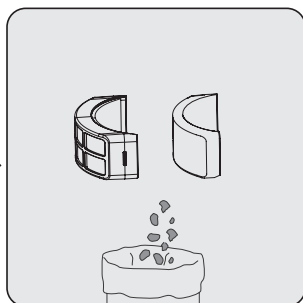

Remove the dust on the EPA E12 filter and outlet foam by tapping them to a hard surface such as a waste bin or by using a brush.

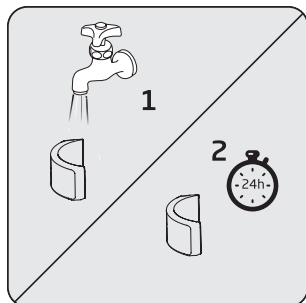

Inspect the outlet foam regularly. Clean it by washing under running cold water after removing the dust on them in case of excessive dust. Reinstall it once it is dried.

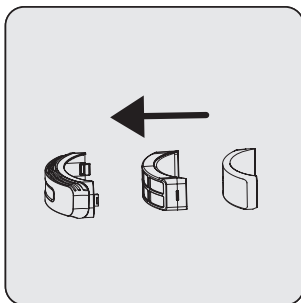

Install the EPA E12 filter and outlet foam to the lid.

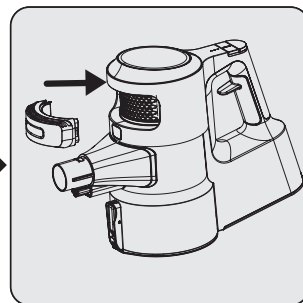

Place the lid back.



**CAUTION:** Wash with cold water. Warm water deteriorates the structure of the filter.



## 5 Cleaning and maintenance

### 5.4 Cleaning of the brush



**CAUTION:** Do not wash the turbo brush (8) and the main roll brush.

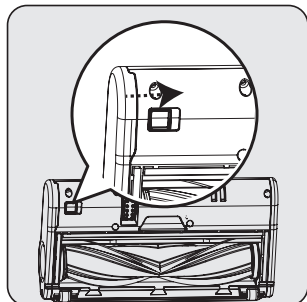

To remove the electric turbo brush (8), keep the roll brush release tab pressed so that the lock shall be opened in the direction of the arrow, rotate the roll cover towards yourself and pull it to the left.

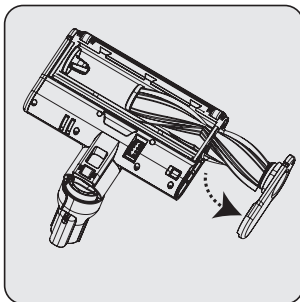

Remove the main roll brush.

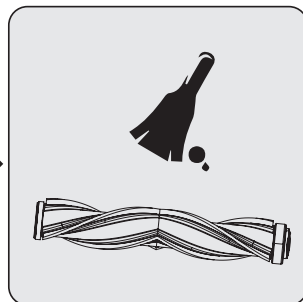

Remove the dust on it by tapping it lightly to a hard surface or remove the dust with a brush. If any hair, etc. is tangled, remove it by cutting it off.

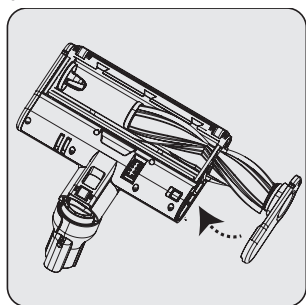

Re-install the main roll brush after cleaning it. A "click" is heard from the tab.

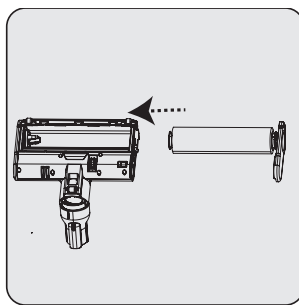

You may replace the main roll brush with delicate hard floor roll as per your preferences.

## 5 Cleaning and maintenance

### 5.5 Removal of the blockages

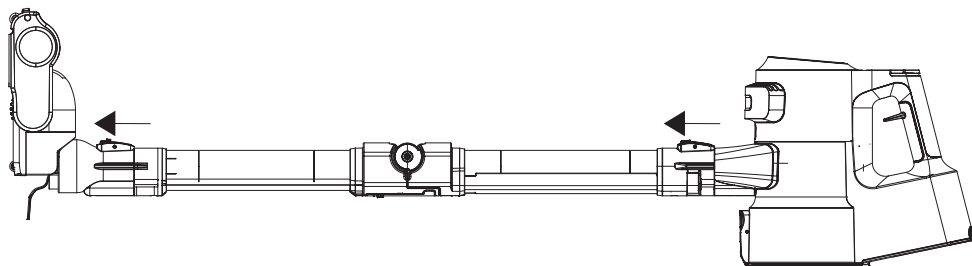

When you see the suction path blockage warning on the screen (4), detach the brush (8) from the tube (6) to remove the blockages. Detach the tube (6) from the body of the appliance (10).

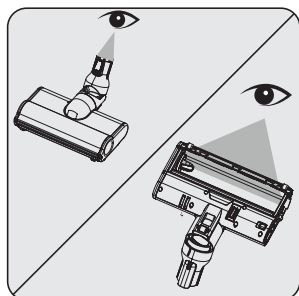

Inspect the connection point of the brush (8) and the vacuum path. Remove any foreign materials.

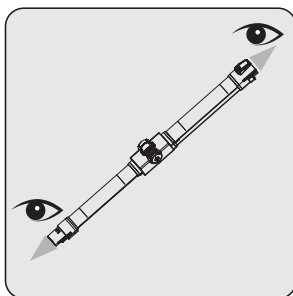

Inspect the inlet and outlet of the foldable tube (6). Remove any foreign materials.

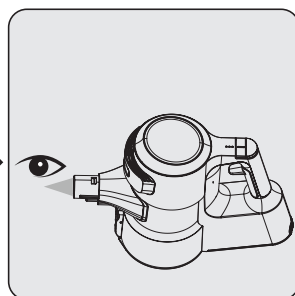

Inspect the vacuum path of the appliance body (10). Remove any foreign materials.

## 5 Cleaning and maintenance

---

### 5.6 Storage

- If you do not plan to use the appliance for a long while, store carefully.
- Unplug the appliance.
- Ensure that the appliance is kept out of reach of children.

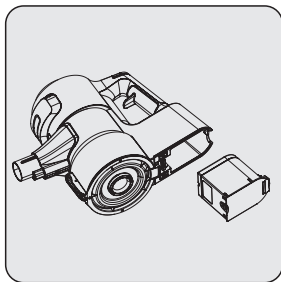

If you shall not be using the appliance for a long period of time, please keep the battery in a cool and dry place at half charged condition after removing it from the appliance. Do not charge or discharge completely.

- Store the battery on a non-conducting material, and do not allow the battery to contact metal directly. This shall damage the battery.

### 5.7 Transportation and handling

- Keep the appliance in its package during transportation and handling. The package will protect the appliance against physical damage.
- Do not place heavy objects on the appliance or the package. The appliance may get damaged.
- If the appliance is dropped, it may malfunction or permanent damage may be inflicted.

## 6 Problems and remedies



**CAUTION:** Check the following points before asking for repair assistance from the service department.

PROBLEM	POSSIBLE CAUSE	SOLUTION
Not operating	Battery is discharged.	Battery is discharged.
	Battery may be unseated.	Remove the battery and install it again.
	Vacuum connection is blocked.	Separate the appliance as body (10), brush (8) and wand (6). Inspect and clean the connection points.
Suction power is reducing.	Dust reservoir (11) is full.	Clean the dust reservoir (11) and the filter.
	You may have reached the cleaning period of the filters.	Clean the filters.
	Filters may be deformed as a result of operation and their replacement period may have come.	Please contact the customer services to buy a new filter.
	Motor inlet foam is not cleaned.	Clean the filters and recharge the appliance.
	Hair and similar materials may have tangled on the rotating roll on the turbo brush (8).	Clean the turbo brush roll.
There is disturbing noise from the motor.	Vacuum connection is blocked.	Separate the appliance as body (10), brush (8) and wand (6). Inspect and clean the connection points.
	Something may have stuck between the dust reservoir and the filter.	Open the dust reservoir and inspect the filter area.
Cannot charge the vacuum cleaner.	The vacuum cleaner is not installed to the charging dock (15).	Install the vacuum cleaner to the charging dock (15). Make sure that it is seated properly. Check the connection.
Operates for a very short time after charging.	It is not charged for the adequate period.	Charge for 4-5 hours as per the instructions.
	Motor inlet foam is not cleaned.	Clean the filters and recharge the appliance.
	Battery life is deteriorated.	Contact the customer services to buy a new battery.
The colour indicator on the screen is illuminated in red.	Your appliance is about to discharged.	Charge it.
The animation indicating that the brush is blocked is displayed on the screen and the appliance has stopped operating.	Hair and similar materials may have tangled on the rotating roll on the turbo brush (8).	Clean the turbo brush roll.

## 6 Problems and remedies

The animation indicating that the vacuum is blocked is displayed on the screen and the appliance has stopped operating.	A blockage has occurred on the vacuum duct.	Remove the blockages.
The animation indicating that the filter is blocked is displayed on the screen and the appliance has stopped operating.	Filters are filled with excessively dust.	Clean the motor inlet foam and the metal filter.
The appliance has stopped operating while being operated. When the appliance is connected to charge, the charging screen is displayed on the screen. But, the battery percentage does not change.	Battery is faulty.	Contact the customer services.
The appliance stopped operating without any warning animation being displayed on the screen.	Battery may be overheated.	Wait for appliance to cool down and try to operate it again.
While charging, 1 LED light on the appliance flashes rapidly in red and the battery percentage on the screen does not change.	You may have inadvertently plugged the adaptor of another appliance, and thus the charge current is excessive.	Use the proper adaptor.
While charging, 1 LED light on the appliance is illuminated solidly in red and the battery percentage on the screen does not increase.	Battery be overheated than expected.	Contact the customer services.
While charging, 1 LED light on the appliance flashes both in red and white alternately and the battery percentage on the screen is not shown as 00%.	The Body (10) is not installed properly to the charging dock (15). Or the battery is not installed properly to the body of the appliance.	Remove the adaptor (19) from the charging dock (15) and remove the body (10) from the charging dock. Ensure that the battery is installed properly on the body. Install the body (10) to the charging dock again and plug the adaptor to the charging dock again.
A bad smell (light humidity, dust, plastic material odour) occurs on the air outlet.	Have you purchased the appliance within the last 3 months?	It is normal that a bad smell (light odour of plastic) occurs within 3 months after the 0purchase date.
	The dust reservoir (11) and the filters are not cleaned properly.	Clean the dust reservoir (11) and the filters.
	Filters may be installed while wet after they are washed.	Remove the filters and ensure that they are dry before installing them to the appliance.
	Filters may be deformed as a result of the frequency of operation and their replacement is required.	Please contact the customer services to buy a new filter.